



## 34 Oxford Road, Lowestoft, Suffolk, NR32 1TW

Recently renovated and beautifully presented throughout, this well-maintained three-bedroom mid-terrace home is ideally located in the heart of North Lowestoft, close to local amenities and transport links. The property features newly fitted flooring throughout and offers bright, modern accommodation including a separate sitting room, a spacious dining area open-plan to the kitchen, and a neutral family bathroom. To the rear, there is a fully enclosed garden with potential for off-road parking. Available soon, this property would make an ideal long-term home.

- Well presented mid terrace
- £850 pcm
- 3 bedrooms
- Fresh and modern décor
- Newly fitted flooring across the property
- UPVC double glazing throughout
- Close to local amenities, shops & schools
- Fully enclosed rear garden
- Gas central heating with combi boiler
- Nearby great transport links

**£850 Per Calendar Month**

GROUND FLOOR  
373 sq.ft. (34.7 sq.m.) approx.

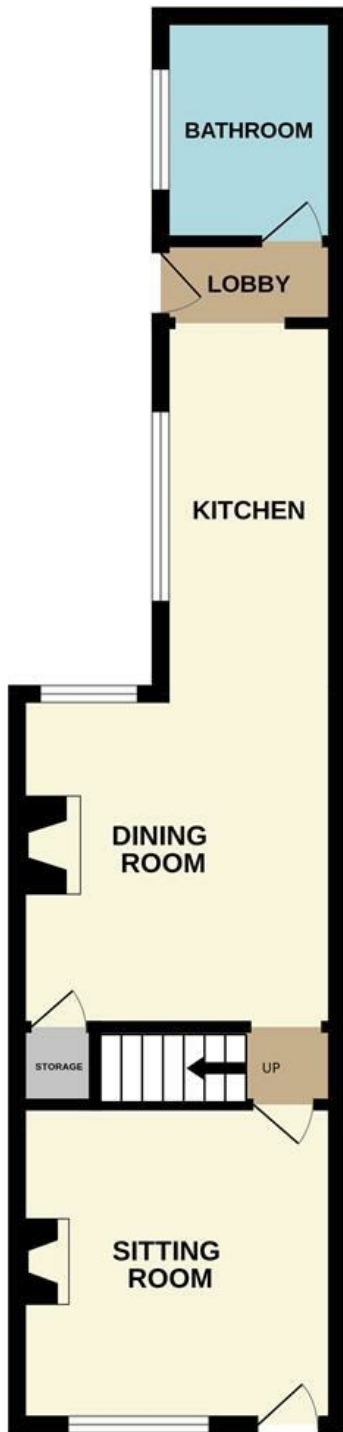

1ST FLOOR  
295 sq.ft. (27.4 sq.m.) approx.



Energy Efficiency Rating		Current	Potential
<i>Very energy efficient - lower running costs</i>			
(92 plus) A			
(81-91) B			
(69-80) C		71	82
(55-68) D			
(39-54) E			
(21-38) F			
(1-20) G			
<i>Not energy efficient - higher running costs</i>			
<b>England &amp; Wales</b>		EU Directive 2002/91/EC	